

JUNCTION BOX SERIES

10 WATT 90-264VAC OR 9-32VDC

Installation Instructions

Product Summary:

In collaboration with the Vision X engineering team, the Imtra Junction Box Series Marine LED Light is specifically designed with the extra protection required to survive life on the open ocean. The stainless-steel hardware, copper circuit boards, tinned extra-long sheathed cables and marine-grade gloss coating are all there to protect the fixture from corrosion and other harmful elements encountered on the water. Additional safeguards such as EMC shielding and transient voltage suppression set these fixtures far above our competition. Each fixture features a 180° ultra wide beam pattern for maximum coverage.

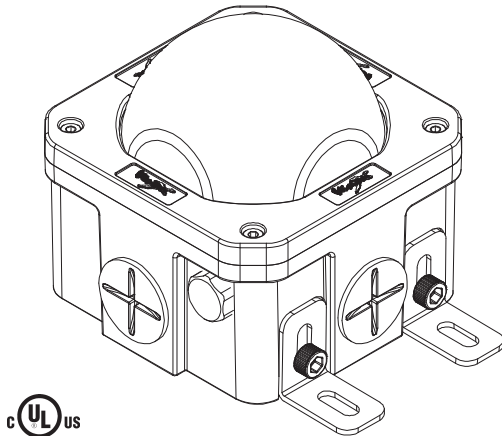

Package Contents:

- (1) All-In-One Junction Box Light Fixture
- (2) Mounting Brackets and Hardware

Tools Required For Assembly

- Philips Head or Flat Head Screwdriver
- 4mm Allen Key
- 6mm Allen Key
- Adjustable Wrench



PLEASE READ ALL INSTRUCTIONS BEFORE INSTALLATION



Safety Instructions:



WARNING: RISK OF ELECTRIC SHOCK

- Installation is intended to be done by a qualified electrician in accordance with the control of hazardous energy (lockout/tagout) safety regulations and procedures.
- Installation must follow the NEC/ABYC/USCG electrical codes set for the specific vessel the fixture is being installed on.
- Ensure **ALL POWER SOURCES** connected to the room or fixture location are turned **OFF** before installation.
- Verify input voltage is within fixture range before installation.
- The use of safety equipment (safety glasses and gloves) are highly recommended.
- Avoid mounting near any combustible material and/or heating units.
- Any maintenance/repairs to the fixture may only be carried out by a qualified electrician.
- Allow proper cooling time before handling the fixture if it has been installed & powered.
- Any modifications to the fixture will automatically void warranty.
- Always inspect the fixture for any damage prior to installing and **DO NOT** install if any damage is present.

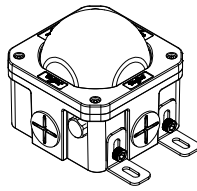

Fixture Dimensions:

2D Front and Side View (in./mm)

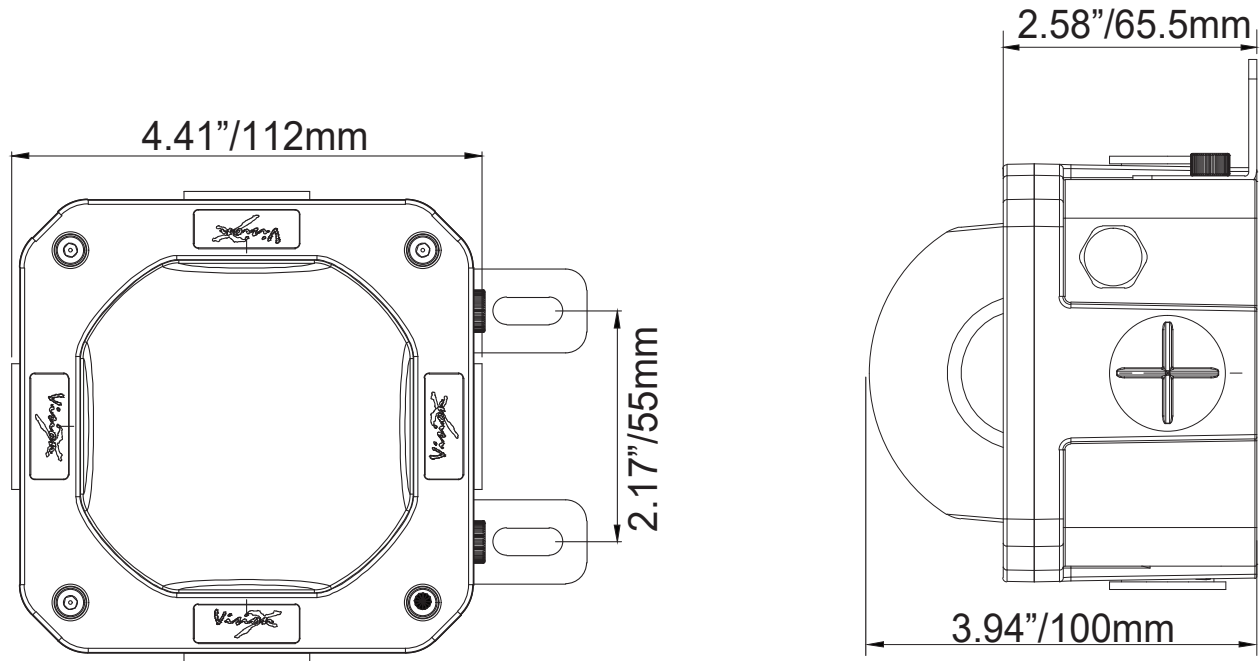

Specifications & Certifications:

Technical Information

Housing Finish/Material	Powder Coated Die-Cast Aluminum
Bracket	Powder Coated Steel
Lens Material	Polycarbonate
Input Voltage	90-264VAC 9-32VDC
Power Consumption	10 WATT
Luminous Flux	1000 Lumens
Correlated Color Temperature (CCT)	5000K
Beam Angle Options	180°
Ingress Protection	IP-68/69K
EMC Emission	Compliance to EN55022, EN61000-3-2 Class A , EN61000-3-3
Certifications & Compliance	CE, ROHS, TR 62778, UL1598A (AC only)
Warranty	5 Years

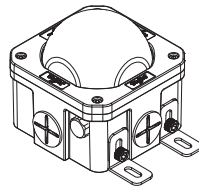

Fixture Mounting Instructions:

Isolation Kit Assembly

Tools Required For Assembly

- 4mm Allen Key
- 6mm Allen Key
- Large Flat Head Screw Driver
- Adjustable Wrench

Isolation Assembly Diagram:

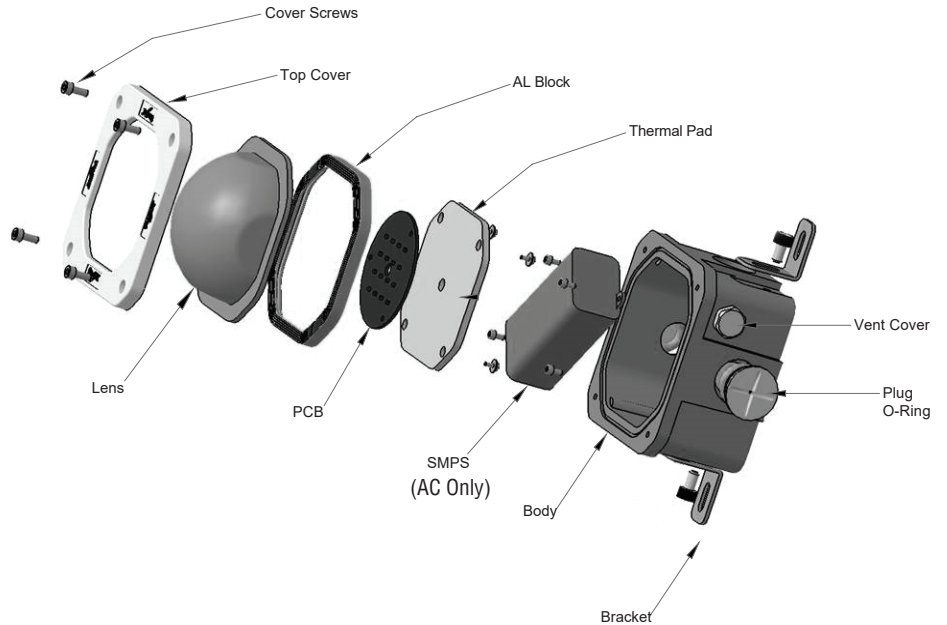

WARNING: Bolts, Nuts, and Washers are Stainless Steel. **DO NOT USE** Pneumatic or Electric Tools to Tighten and Loosen. The **Hardware Will Permanently Seize Together.**



Recommendations:

- For all threaded fasteners we recommend using Loctite LB 8023™ Marine Grade Anti-Seize.
- Coat under the top of the bolt head as well as the entire bottom end of the bolt thread where the nut will be threaded on.

Mounting Instructions:

- Find a suitable surface for the light fixture and mark mounting hole location.
- Allow for ~25mm around the housing on all sides to permit convective cooling of the heat sink. Flush mounting is not permitted and will void warranty.
- Use 6mm allen key to mount supplied bracket to housing.
- Mount light to surface.
- Remove o-ring plug and thread in either conduit fitting or cable gland (not supplied).
- Use adjustable wrench to tighten making sure not to over tighten and crush o-ring.
- Use 4mm allen key to remove the four bolts on the top cover.
- Remove top cover and lens to access internal power supply.
- For VAC models, use supplied connectors. Connect ACL, ACN, and Earth Ground wires. (See wiring instructions on page 4)
- For VDC models, connect red to POS+ and black to NEG -.
- Secure lens and top cover back on the housing. Tighten cable gland or conduit fitting around incoming wiring.
- Connect conduit to fitting.
- Test light operation.

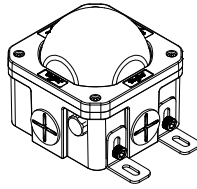

Fixture Wiring Instructions:

Wire Functions / Drip & Service Loop / Cable Gland

America Wire Definitions:

Wire Functions

White Wire = AC-N (Neutral) —●—
Black Wire = AC-L (Line) —●—
Green Wire =  Grms (Earth Ground) —●—

Europe Wire Definitions:

Wire Functions

Blue Wire = AC-N (Neutral) —●—
Brown Wire = AC-L (Line) —●—
Green/Yellow Wire =  Grms (Earth Ground) —●—

DC Wire Definitions:

Wire Functions

Red Wire = + (Positive) —●—
Black Wire = - (Negative) —●—

Recommendations:

- A Drip / Service loop should be used to ensure water does not run down the wire towards the fixture as well as provide adequate space for the fixture to move if removal or service is required.
- A waterproof cable gland should be used where the cable passes into the vessel to ensure a watertight seal.

Wiring Instructions (AC) :

- Connect the Black or Brown Wire (AC-L) to your Line AC power source using supplied wago connector.
- Connect the White or Blue Wire (AC-N) to your neutral circuit using supplied wago connector.
- Connect the Green or Green/Yellow Wire ( Earth Ground) to your grounding source.
- Test light operation.

Wiring Instructions (DC) :

- Connect the Red Wire (Positive) to your positive wire using supplied wago connector.
- Connect the Black Wire (Negative) to your negative wire using supplied wago connector.
- Test light operation.

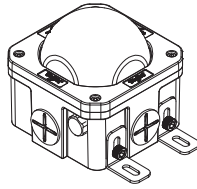

Warranty Information:
Rules and Regulations



Rules and Regulations:

- Proof of purchase is required to validate warranty and is valid from the original date of purchase. All products must be bought through Imtra Corp., an Imtra Corp. Authorized Dealer, or one of their dealers/resellers.
- Improper installation, accident, physical damage, neglect, and normal wear are not covered under warranty.
- Lights operated in environments over 150° Fahrenheit are not covered under warranty.
- Warrantied items will be repaired to working condition and returned without cosmetic alterations.
- Warranties should be handled through the dealer/reseller the product was purchased from; customer is responsible for delivery.
- If product is not under warranty, customers will be responsible for return shipping charges.
- Additionally, non-warranted items can be repaired at the customer's expense of parts and labor, at the discretion of Imtra Corp., who will provide an estimated repair cost before proceeding with the repair.

Installation Notes:
