

INSTALLATION INSTRUCTIONS

DISASSEMBLY:

REMOVE THE GRUB SCREW FROM THE PAWL (2) WITH AN ALLEN KEY AND SLIDE SHAFT OUT

ASSEMBLY:

1: PLACE THE PAWL (2) IN POSITION AND SLIDE DEVILS CLAW HANDLE (3) THROUGH CHAINLOCK AND PAWL

2: SLIDE NYLON WASHER (6) AND ARM LOCK (4) ONTO SHAFT END

3: APPLY LOCTITE TO THE CSK SCREWS' (8) THREAD, SLIDE SS WASHER (7) ONTO SCREW BEFORE SCREWING INTO THE CHAINLOCK HANDLE

4: APPLY LOCTITE TO PIN THREAD (5) AND AND SCREW INTO SIDE OF CHAINLOCK BASE (1)

5: APPLY LOCTITE TO GRUB SCREW (9) AND FIX PAWL TO SHAFT AFTER ALIGNING THE THREADED HOLE AND FLAT ON SHAFT.

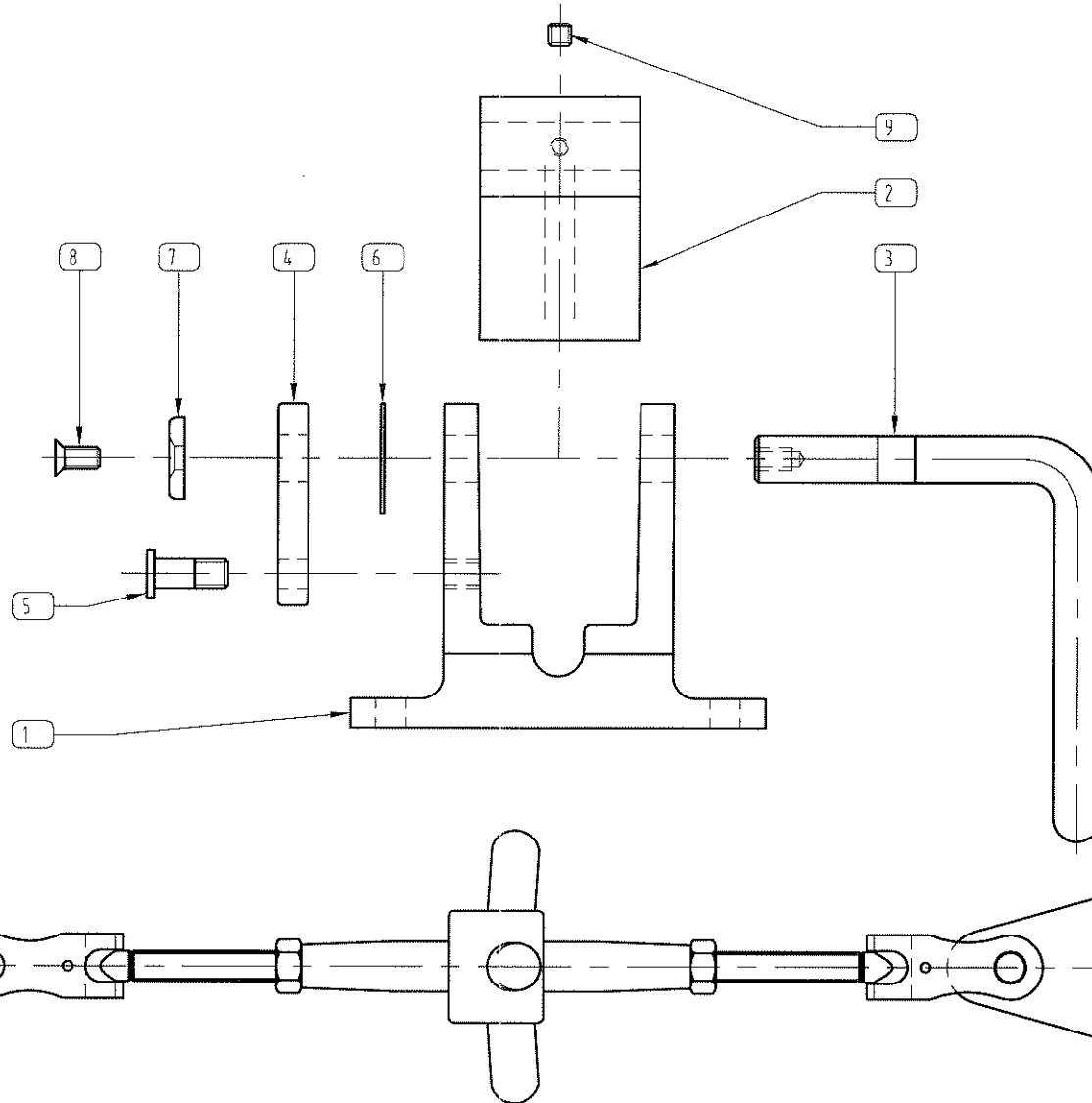

TOLERANCES (mm)	
X.	±
X.X	±
X.XX	±
UNLESS OTHERWISE SPECIFIED	
MATERIAL	
FINISH	

MUIR WINDLASSES AUSTRALIA			
TITLE DEVILS CLAW CHAINLOCK KIT INSTALLATION DIAGRAM			
PART No.			
DRN AC	DATE 18/12/02	DRG No. CHAIN LOCK KIT INSTALL	
SCALE NTS	APP1 <i>[Signature]</i>	APP2 <i>[Signature]</i>	SIZE A4
© COPYRIGHT MUIR ENGINEERING PTY. LTD.			