

WS 63 "FYNSPRAY" ROCKER GALLEY PUMP (Mk 3)

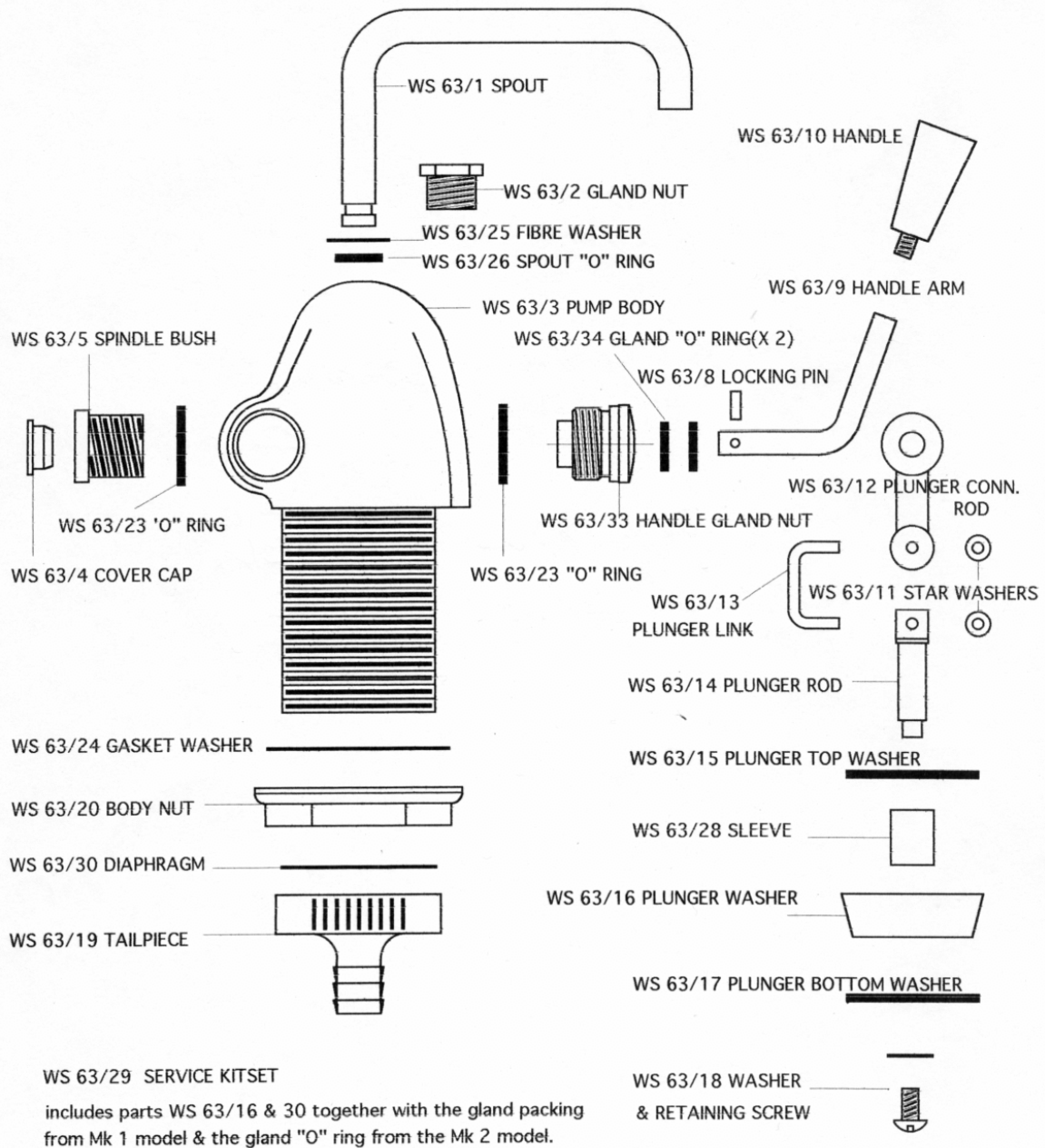

FROM NEW ZEALAND
FYNspray WS 63 GALLEY PUMP

MAINTENANCE INSTRUCTIONS:

Fynspray pumps are manufactured from the highest quality materials and are practically maintenance free. However, as with most moving parts, the pump will operate more smoothly with periodic lubrication. Details described below.

PUMP HANDLE GLAND -

1. Unscrew the gland nut (W.S. 63/7) and apply a little light grease or Vaseline to 'O' ring (W.S.63/27)
2. Replace the gland nut and tighten finger tight only. Do the final adjustment when the pump is tested, and then only tighten to stop any seepage around the handle spindle.

SPOUT GLAND -

1. Unscrew the spout gland nut (W.S. 63/2) and apply a little light grease or Vaseline to 'O' ring (W.S. 63/26).
2. Replace the spout and gland nut, and screw down the gland nut sufficiently to compress the rubber washer slightly to avoid leakage at this point.

Avoid over tightening.

LOSS OF SUCTION -

This can be caused by foreign matter becoming lodged in the tailpiece valve seat (W.S. 63/19) area or beneath the plunger washer (W.S. 63/16), which would prevent these valves from seating. Also a badly worn plunger washer (W.S. 63/16) could cause loss of suction.

1. Unscrew the tailpiece and remove diaphragm to make a visual inspection.
2. Unscrew the retaining nut (W.S. 63/20) and remove the pump from the bench top for inspection of the plunger assembly.
3. To check the rubber cup washer - unscrew the retaining screw (W.S. 63/18) and remove the bottom plunger washer, (W.S. 63/17) then the rubber cup washer(W.S. 63/16) and inspect for wear. This washer should not be smaller in diameter than the inside of the pump body.
4. Test this by placing the washer upside down in the end of the pump body.
 - a. If it falls freely to the bottom then the pump would probably not have very good self priming ability, and a new washer should be fitted.
 - b. If when sitting in the end of the pump body the washer stands up more than 2 millimetres above the body end, then the washer is too large and will probably bind and make operation difficult (it has been known for washers to swell under some water conditions). A new washer should be fitted.

NOTE:- water should be sufficient lubrication for the rubber cup washers, and additional lubrication unnecessary.

5. Reassemble the pump, using a gasket joint sealant on the screw (W.S. 63/18) to prevent it from unscrewing during operation. Avoid over tightening tailpiece and buckling diaphragm.
6. Test the pump before re-installing it into the countertop.

IMTRA CORPORATION
30 Barnet Boulevard, New Bedford, MA 02745
PH: (508)995-7000 FAX: (508)998-5359