

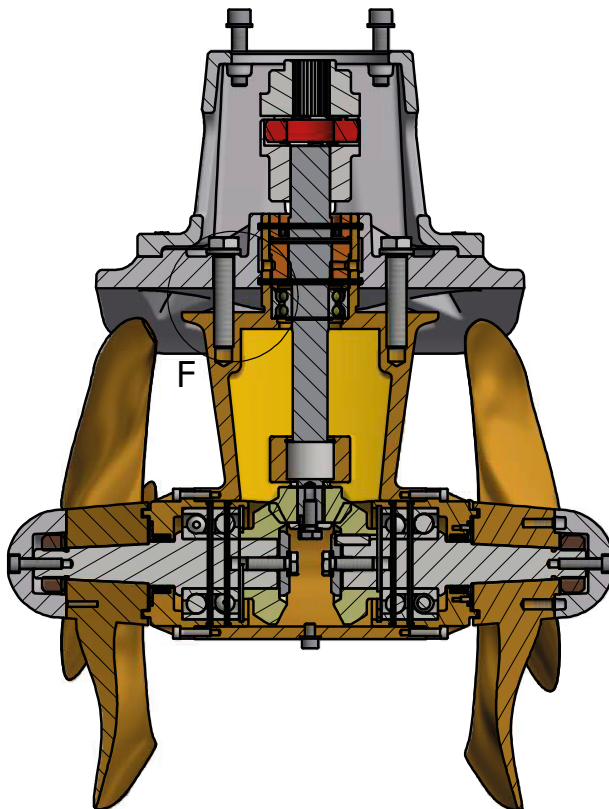

Isolation kits for steel/aluminium tunnels

NEW



F (1 : 1)

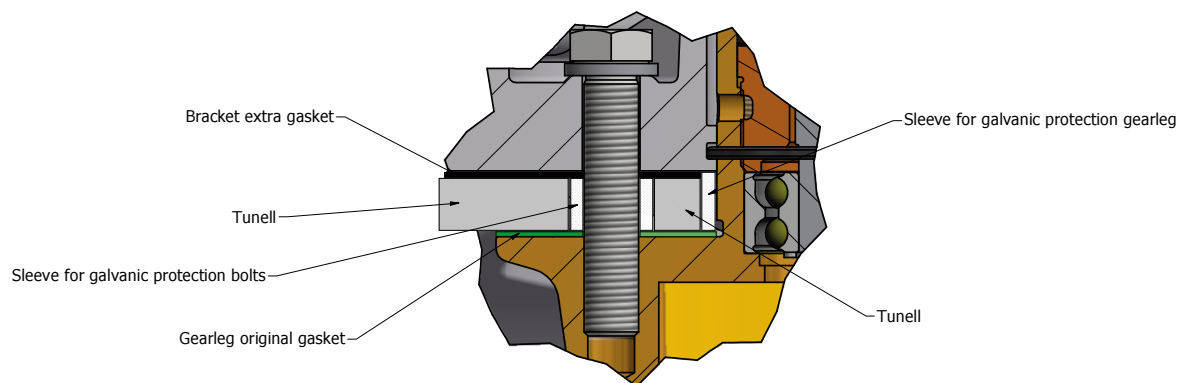



SE80 - SE/SH300 / Ø185mm - Ø300mm

- Thrusters with insulated aluminium bracket and pre-filled with oil:
- We recommend the aluminium tunnel to be coated with epoxy primer.
- Gearleg bolts in stainless steel must be insulated from the aluminium tunnel with a sleeve or equal for galvanic insulation.
- Brackets are in aluminium, so there is a risk for B+ connection to aluminium hull.
- We recommend an extra gasket as safety and insulation between bracket and tunnel.

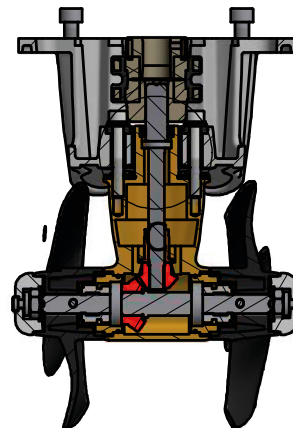
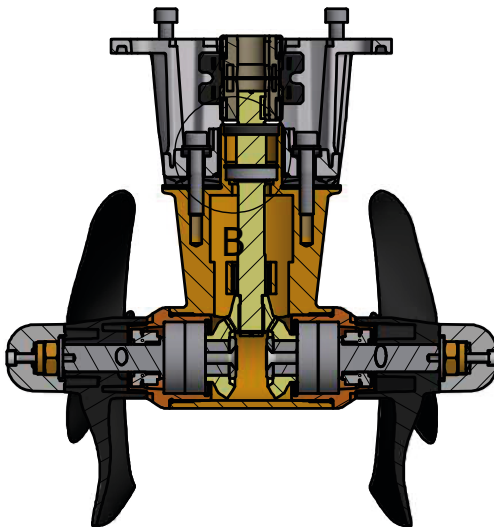
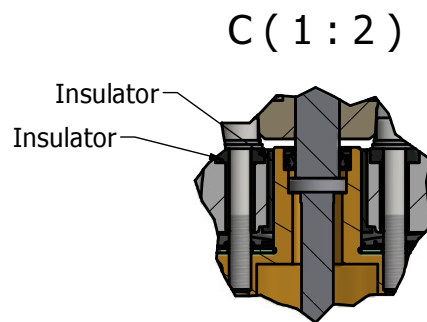
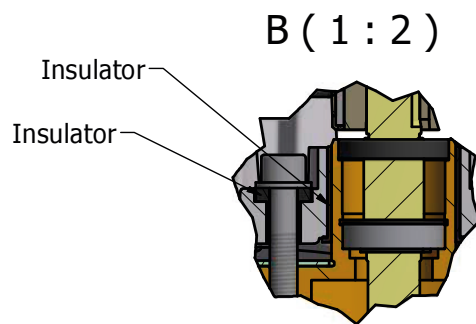

DRILLING TEMPLATE

Diameters must be adjusted in the tunnel:

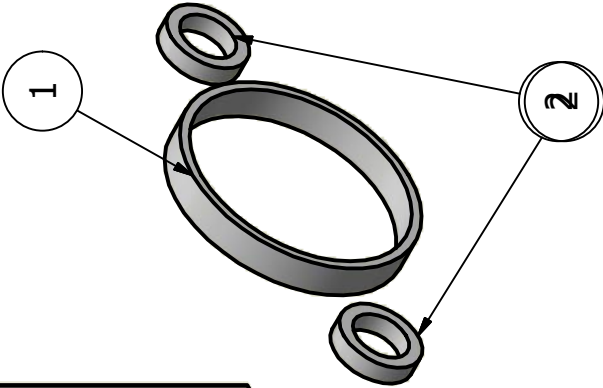
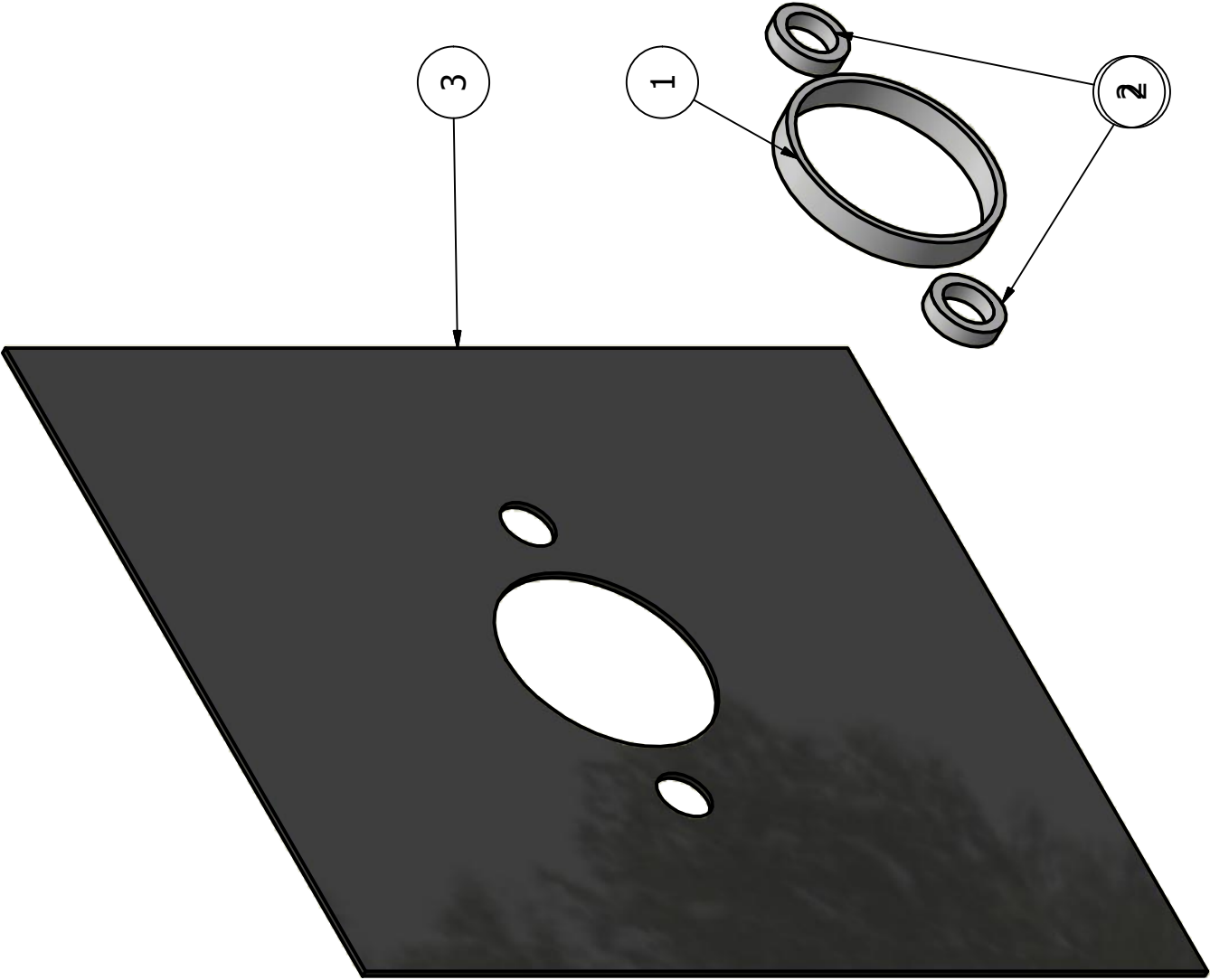
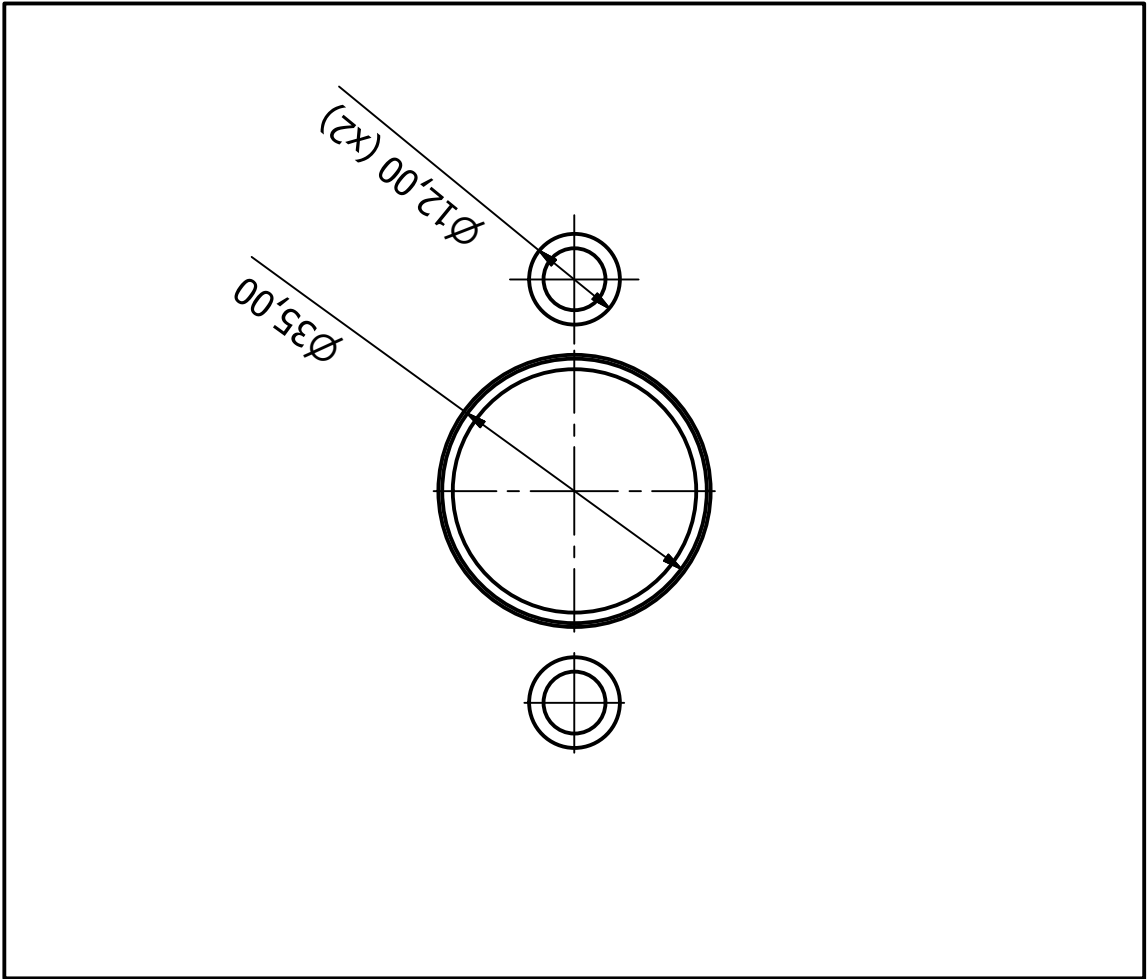

IT	QT	DRAWING NO	STOCK NO	TITLE	MATERIAL
1	1	SM-128261	SM-128261	Galvanic protection/gearhouse (Ø185 tunnel)	Acetal Resin, White
2	2	SM-128262-01 3mm	SM-128262 h3	Galvanic protection for bolts M8 (Ø110-125 tunnel)	Acetal Resin, White
3	1	SM-127908	SM-127908	Gasket for galvanic insulation for bracket	INCA

Title		Isolation kit for steel/alu hulls Ø185			
Part nr		Side Power thrusters SE80/100			
7 1320		Weight	Size	Scale	Sheet
		0,019 kg	A3	1 : 1	1 / 1



Installation instructions

1. Use the standard drilling template or gasket to mark the centre of the holes on the tunnel correctly.
2. Use the correct and relevant isolator kit measurement drawing and drill the holes in accordance with measurements.
3. Place the isolator parts in position and fasten gearleg and bracket according to Thruster Installation manual.
- 4.

IMPORTANT! Some isolation kits have a gasket included, remember always to place it between the tunnel and motor bracket.

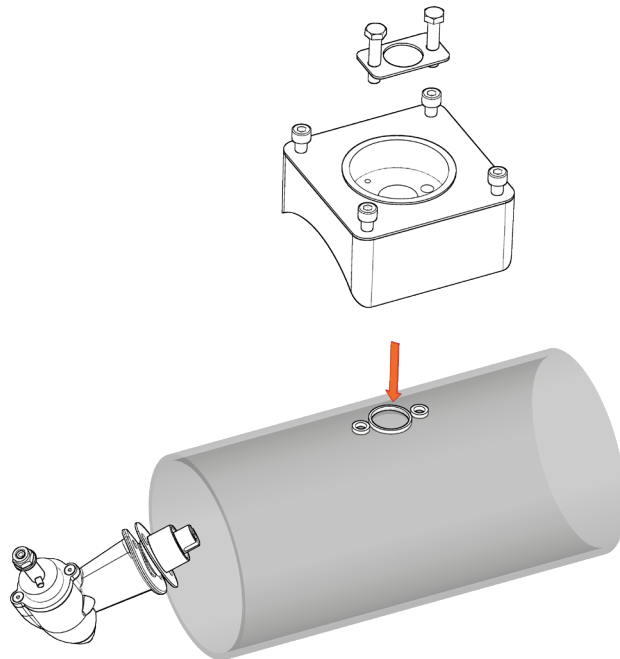
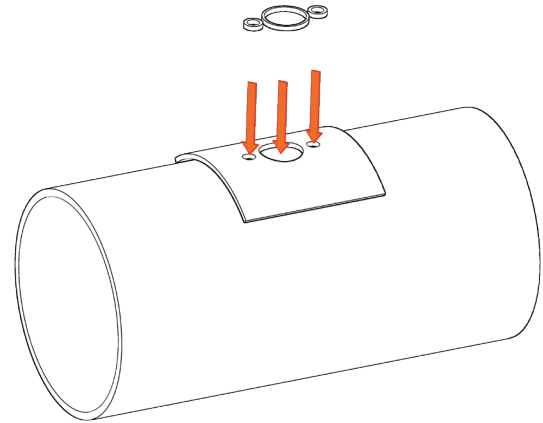

This document may contain typographical errors and changes, to which Sleipner Motor assumes no responsibility.



Sleipner Motor AS
P.O. Box 519,
N-1612 Fredrikstad, Norway
www.side-power.com



Confidence by Control

SIDE-POWER.com