

WS 62 *Fynspray* CLASSIC LEVER GALLEY PUMP

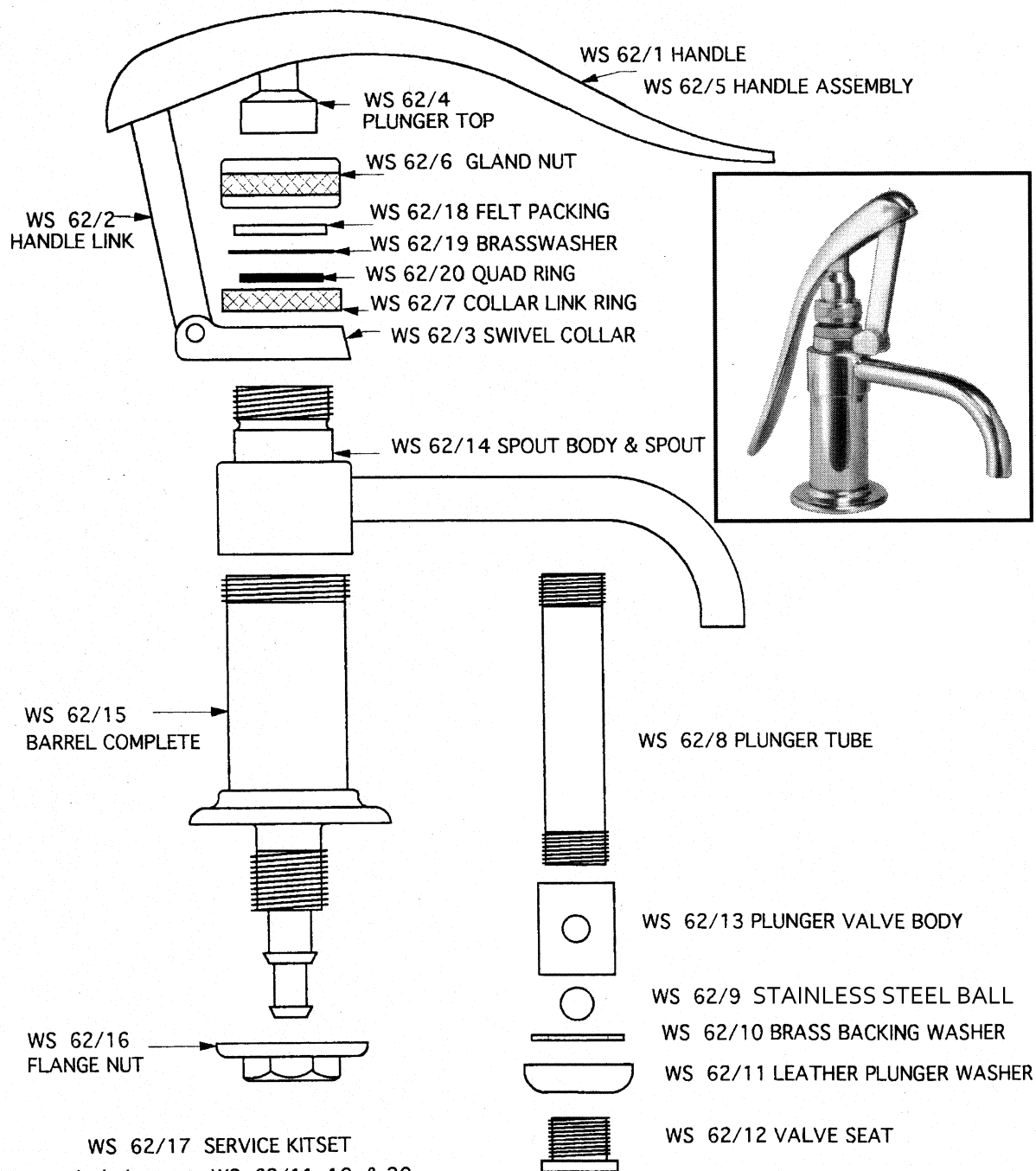

WS 62/17 SERVICE KITSET
includes parts WS 62/11, 18, & 20
and the gland packing from the earlier model
which parts 18,19, & 20 have replaced.

WS 62 Repair Instructions

To replace the leather plunger washer (#11)

Unscrew the spout body & spout assembly (#14) from the barrel assembly (#15). (As sealant has been used on the thread, run the spout body under hot water and then tap it gently with a soft-headed mallet or a piece of soft wood. Place the pump vertically in a bench vice, gripping the barrel assembly below the flange.) DO NOT use too much force on the spout & DO NOT use any tools as they may cause damage to the barrel. The complete handle & plunger assembly can now be removed. By holding the plunger valve body (#13) in a bench vice, the valve seat (#12) can be unscrewed, enabling the leather cup washer to be replaced.

To replace the gland packing on Mk 1 model

Unscrew the gland nut (#6) and remove the old gland packing before winding the replacement packing around the plunger tube (#8). Apply a little vaseline to the packing to help it seat itself in position.

To replace the felt packing (#18) & quad ring (#20) on Mk 2 model

The complete plunger valve assembly must be removed from the plunger tube (#8). Take care when fitting the quad ring so as not to damage its inside edge.

If your pump is not leaking at the gland, there is no necessity to replace either of the above