

## F-4 Chart Light

The F-4 series is a new generation LED task light that is the result of combining high-tech components with high-tech functionality. The F-4 incorporates a cutting-edge microcontroller with the latest high-power Light-Emitting-Diodes (LEDs). Use of LED's results in miniscule power consumption, low operating temperature, vibration resistance, and extremely long life. The high tech microcontroller allows the end-user to take complete control of his/her lighting with a simple touch of one's finger.



### FEATURES

- Flexible umbilical (gooseneck) design chart light
- TouchLED switch technology
- Bulkhead and table mount options
- Programmable "red" nightlight function



Bulkhead mount

## Advanced LED Solutions

Imtra is at the forefront in the development of LED products for today's marine market. We are proud to offer a family of first-in-class high flux LED lights that combine proprietary drive electronics with advanced optics and efficient thermal management techniques. Imtra PowerLEDs let builders and boat owners enjoy all the advantages of the latest LED technology, backed by Imtra's expertise and support. To see our full line of LED products, visit [www.imtra.com](http://www.imtra.com).

### An excellent choice for:

- Chart tables
- Desks
- Bunks

[www.imtra.com](http://www.imtra.com)

## PRODUCT DETAILS

### Visual

#### Color Options

Cool  
White

#### Beam Angle

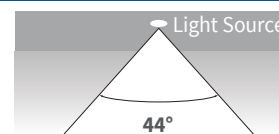

#### Finish



Black  
IP50

### Mechanical

#### Housing Material

Stainless Steel, Aluminum, Electro-Plated Steel

#### Mounting Method

Screw-mount

#### Dimensions

<b>A</b>	Shade Dimensions	Ø1.97"	50mm
<b>B</b>	Base Diameter	1.36"	35mm
<b>C</b>	Full Extension	11.81"/19.68"	300mm/500mm

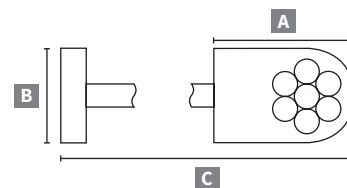

### Electrical

#### Power Consumption

2W

#### Voltage

10-30VDC

#### Protections

Reverse Polarity, Surge Protection

#### Lumens

85 lm

### Certifications

