

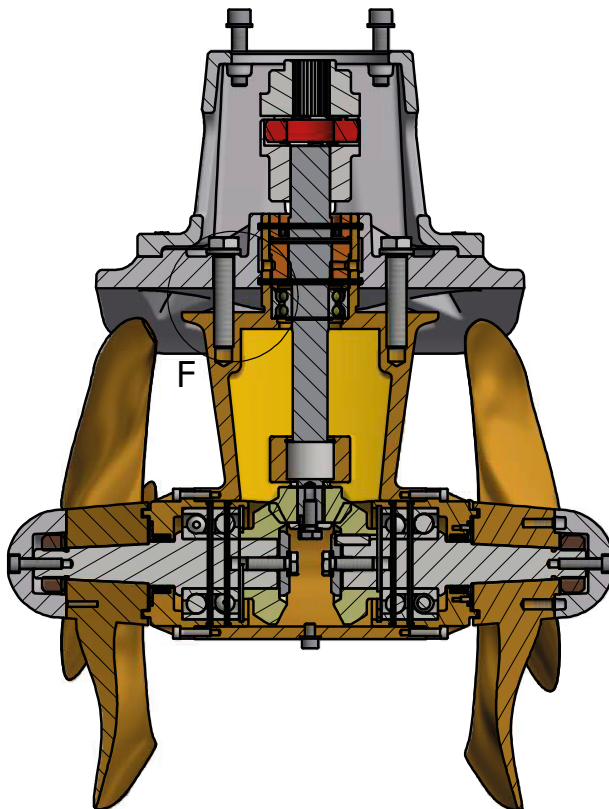

Isolation kits for steel/aluminium tunnels

NEW



F (1 : 1)

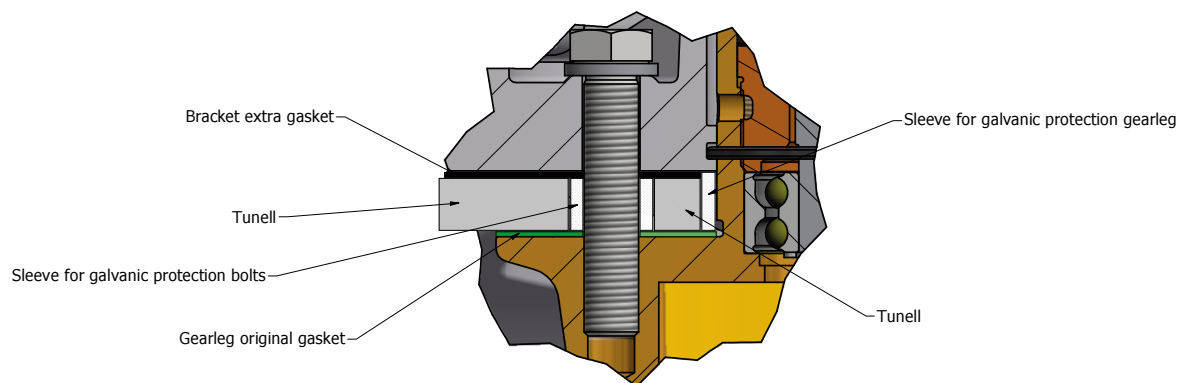



SE80 - SE/SH300 / Ø185mm - Ø300mm

- Thrusters with insulated aluminium bracket and pre-filled with oil:
- We recommend the aluminium tunnel to be coated with epoxy primer.
- Gearleg bolts in stainless steel must be insulated from the aluminium tunnel with a sleeve or equal for galvanic insulation.
- Brackets are in aluminium, so there is a risk for B+ connection to aluminium hull.
- We recommend an extra gasket as safety and insulation between bracket and tunnel.

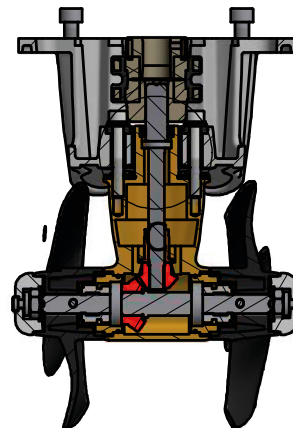
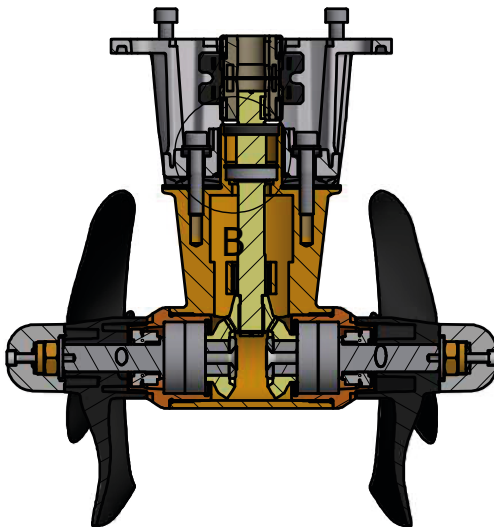
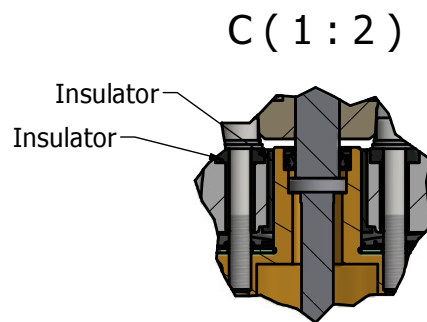
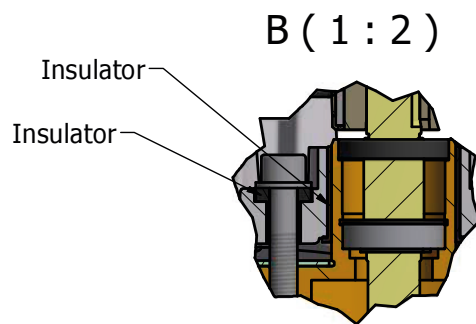

DRILLING TEMPLATE

Diameters must be adjusted at the tunnel:

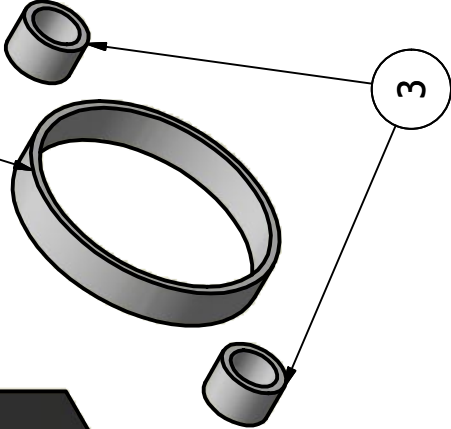
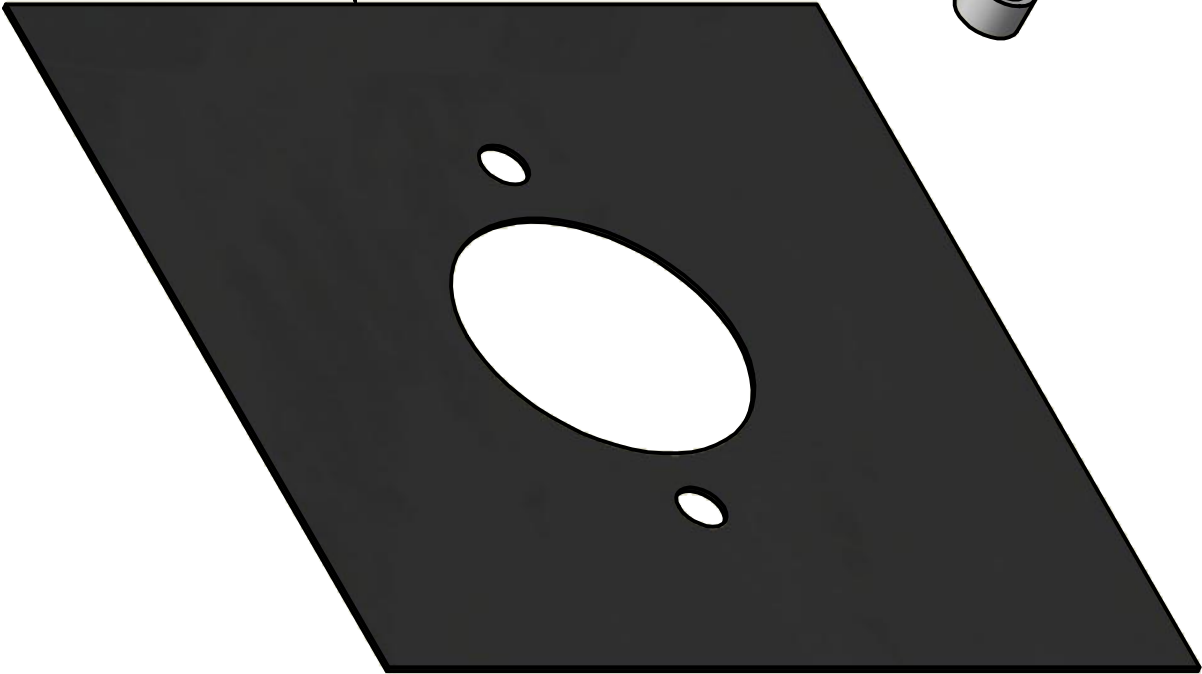
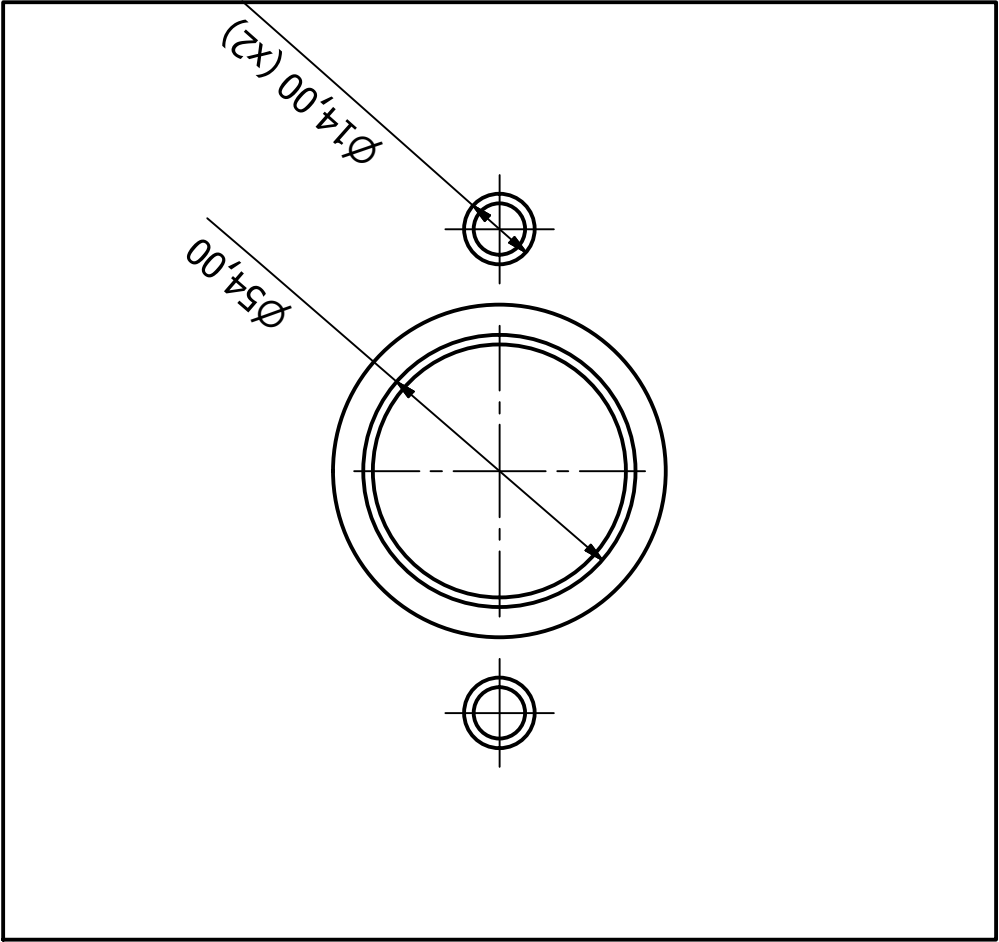

ITEM	QTY	DRAWING NO	STOCK NO	TITLE	MATERIAL
1	1	SM-128392	SM-128392	Galvanic protection in steel/alu hulls Ø300 tunnel	Acetal Resin, White
2	1	SM-127816	SM-127816	Gasket for galvanic insulation for bracket	INCA
3	2	SM-128268-02	SM-128268 h9	Galvanic protection/bolts M10	Acetal Resin, White

Designed by	Material Type	Date	Drawing nr	Tolerance NS-ISO 2768-1
Elvira H.		14.06.2017	SM-128396	

Copyright All rights reserved		Title	
SHIPNORMORAS		Isolation kit for steel/alu hulls Ø300 tunnel	
SidePower thrusters SE240-285 (SH300/350)			

Part nr	Weight	Size	Scale	Edition	Sheet
20 1320	0,037 kg	A3	1 : 1,5	1	1 / 1



Installation instructions

1. Use the standard drilling template or gasket to mark the centre of the holes on the tunnel correctly.
2. Use the correct and relevant isolator kit measurement drawing and drill the holes in accordance with measurements.
3. Place the isolator parts in position and fasten gearleg and bracket according to Thruster Instalation manual.
- 4.

IMPORTANT! Some isolation kits have a gasket included, remember always to place it between the tunnel and motor bracket.

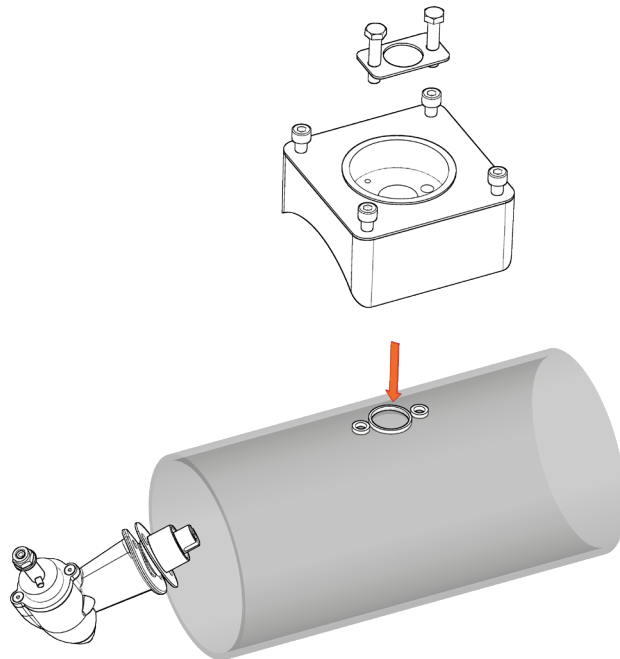
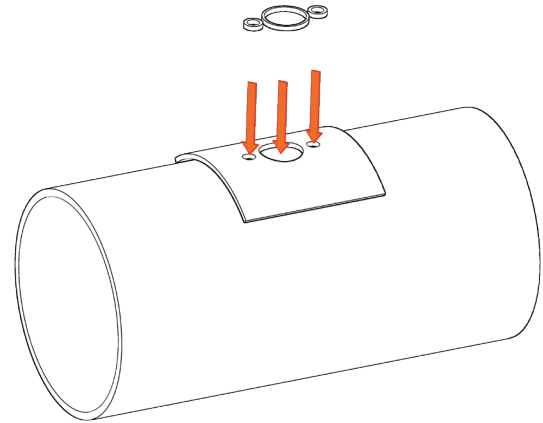

This document may contain typographical errors and changes, to which Sleipner Motor assumes no responsibility.



Sleipner Motor AS
P.O. Box 519,
N-1612 Fredrikstad, Norway
www.side-power.com



Confidence by Control

SIDE-POWER.com